

### Residence 3

- ⌘ **Floor 5 Through 36**  
2 bedroom 2 1/2 bath with breakfast room
- ⌘ **Enclosed Area**  
1,558 sf 144.7 sm
- ⌘ **Balcony Area**  
259 sf 24.0 sm

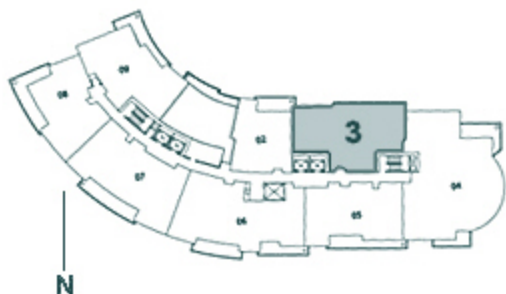

Sculpted to Perfection.

Not to scale. All dimensions are approximate and all floor plans and development plans are subject to change in accordance with the agreement for sale. Oral representations cannot be relied upon as correctly stating the representations of the developer. For correct representations, make reference to the documents required by Section 718.503 Florida Statutes to be furnished by developer to buyer or lessee. Stated dimensions are measured to the exterior boundaries of exteriors walls, corridor walls and to the centerline of interior demising walls and may vary from the description and definition of the "Unit" set forth in the Declaration.